

PRODUCT DESCRIPTION

- Masking the uneven edges of grooves
- Easy mounting
- Profile height not exceeding the thickness of drywall

FINISH :

Silver anodized ☐

*Custom colors available upon request

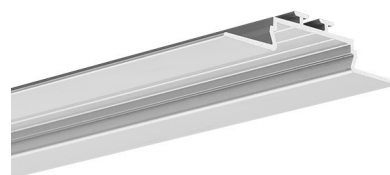

Fill empty fields

Product nr.	
Fixture type	
Company	
Job name	
Date	

TECHNICAL SPECIFICATION

Application

- construction of lighting fixtures in shallow grooves

Assembly

- in grooves with KMA mounting springs or with mounting adhesive.

Additional information

- wide flange not requiring a precise groove

AVAILABLE LENGTHS

Ref. nr.	surface finish	available lengths
B6164ANODA_1	Silver anodized	1000 mm
B6164ANODA_2	Silver anodized	2000 mm
B6164ANODA_3	Silver anodized	3000 mm

TECHNICAL DRAWING

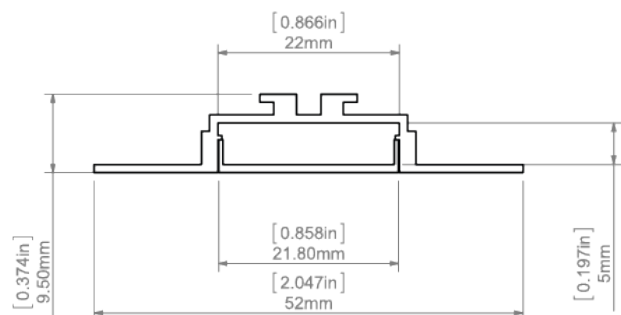

RELATED PRODUCTS

COVERS

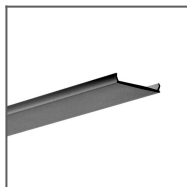

LIGER-22 black Cover
Ref: 17044

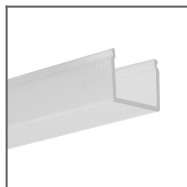

G-K semi-transparent
Cover
Ref: 00415

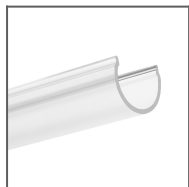

G-L clear Cover
Ref: 17006

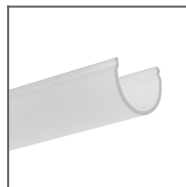

G-L semi-
transparent Cover
Ref: 17008

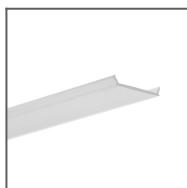

MUN-22 semi-
transparent Cover
Ref: 17042

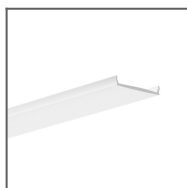

LIGER-22 frosted
Cover
Ref: 17032V1

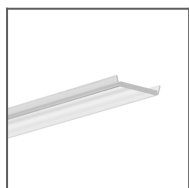

HS-22 clear Cover
Ref: 17022

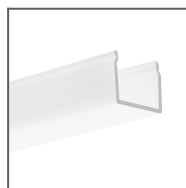

G-K frosted Cover
Ref: 17007

100°



110°

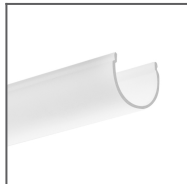

G-L frosted Cover
Ref: 00413

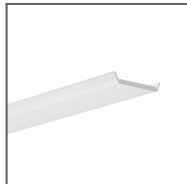

HS-22 frosted Cover
Ref: 17011

110°



END CAPS

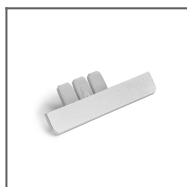

OPAC-30
metalized End
cap
Ref: 24052

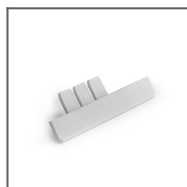

OPAC-30 grey End
cap
Ref: 24045

ACCESSORIES

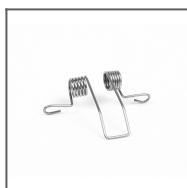

KMA Spring
Ref: 00838V1



Gland M8X1
Ref: 42265

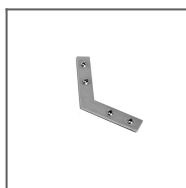

ZM-120
Connector
Ref: 42728

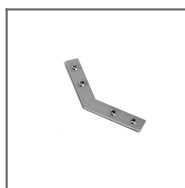

ZM-135
Connector
Ref: 42720

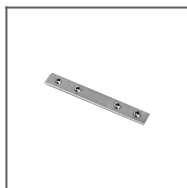

ZM-180
Connector
Ref: 42717

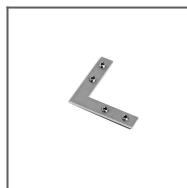

ZM-90 Connector
Ref: 42716

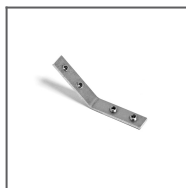

ZM-PION-135
Connector
Ref: 42719



ZM-PION-90
Connector
Ref: 42718